



# FIAT PUNTO



**MESSAGE  
READER  
INSTALLATION**

# INSTALLATION PROCEDURE

1. Enter the **Blue&Me™** portal from the official FIAT web site and download the .zip file containing the Message Reader application package to be installed on **Blue&Me™**.
2. Open the .zip file downloaded from the **Blue&Me™** portal, you are recommended to extract it to a dedicated folder (ex.: c:\Blue&Me).
3. From extracted files, copy into a previously formatted USB storage device the following files:
  - install.inf**
  - SMS\_Reader.ARM920.CAB**
4. The USB storage device will therefore contain these two files:
  - install.inf**
  - SMS\_Reader.ARM920.CAB**
5. Connect the USB storage device to the **Blue&Me™** USB port in the car (glove compartment, see the picture).
6. Turn the ignition key of the car to **MAR**.
7. **Blue&Me™** will show on the instrument panel display the message **"UPDATING"** and it will say **"update started"** (Failing this procedure, turn the ignition key back to **STOP** and then to **MAR** again).

**WARNING** No control button on the steering wheel shall be pressed during the update procedure.

8. When update is completed, **Blue&Me™** will show on the instrument panel display the message **"COMPLETE"** and it will say **"Update complete, please remove the USB memory"**.

9. Press button **MAIN** and then use buttons **▲/▼** to find the menu option **"MESS. READER"** in the **Blue&Me™** Main Menu.

**Repeat the above procedure right from the start if the option "MESS. READER" is not present in the Blue&Me™ Main Menu (performed procedure was unsuccessful).**

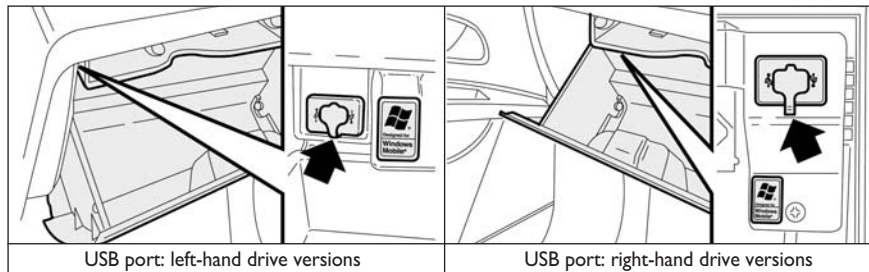
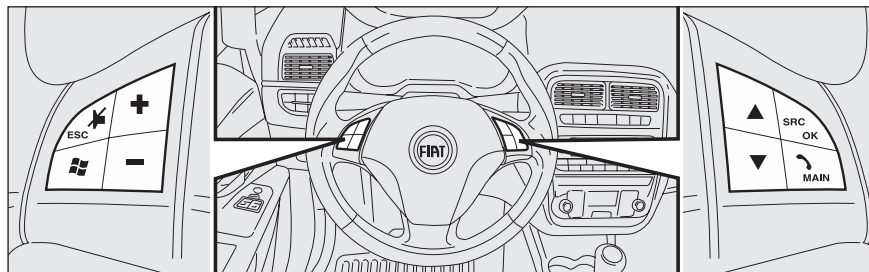

USB port: left-hand drive versions

USB port: right-hand drive versions